

- SUMMARY OF PROPOSED WORKS REQUIRING PERMISSION**
- Flat roof section replace with grey single ply membrane with upper level having standing seam detail.
 - Rooflights (RL1/2/3/4 & Loft Access RA1) to be replaced with conservation rooflights/roofed over

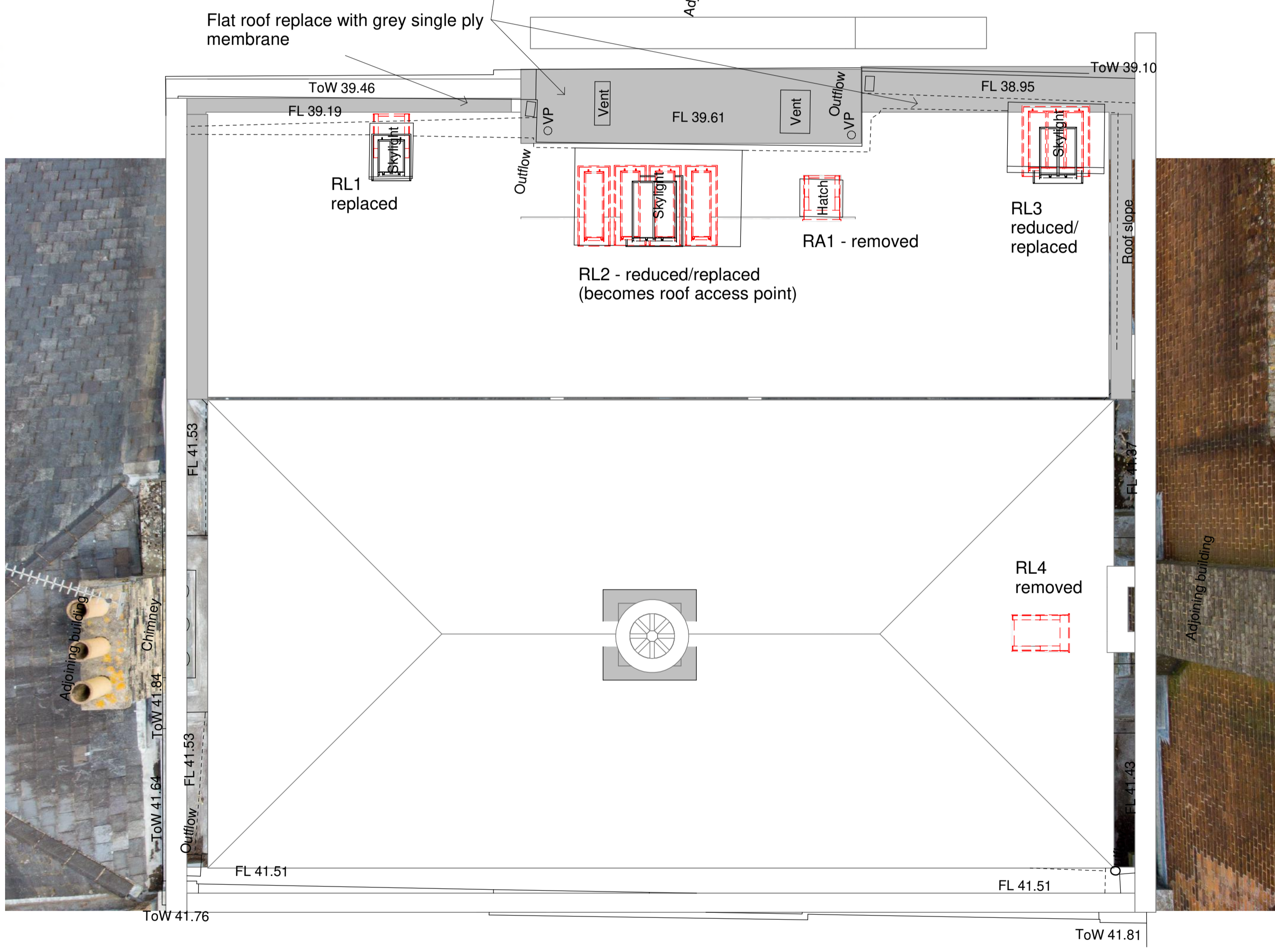
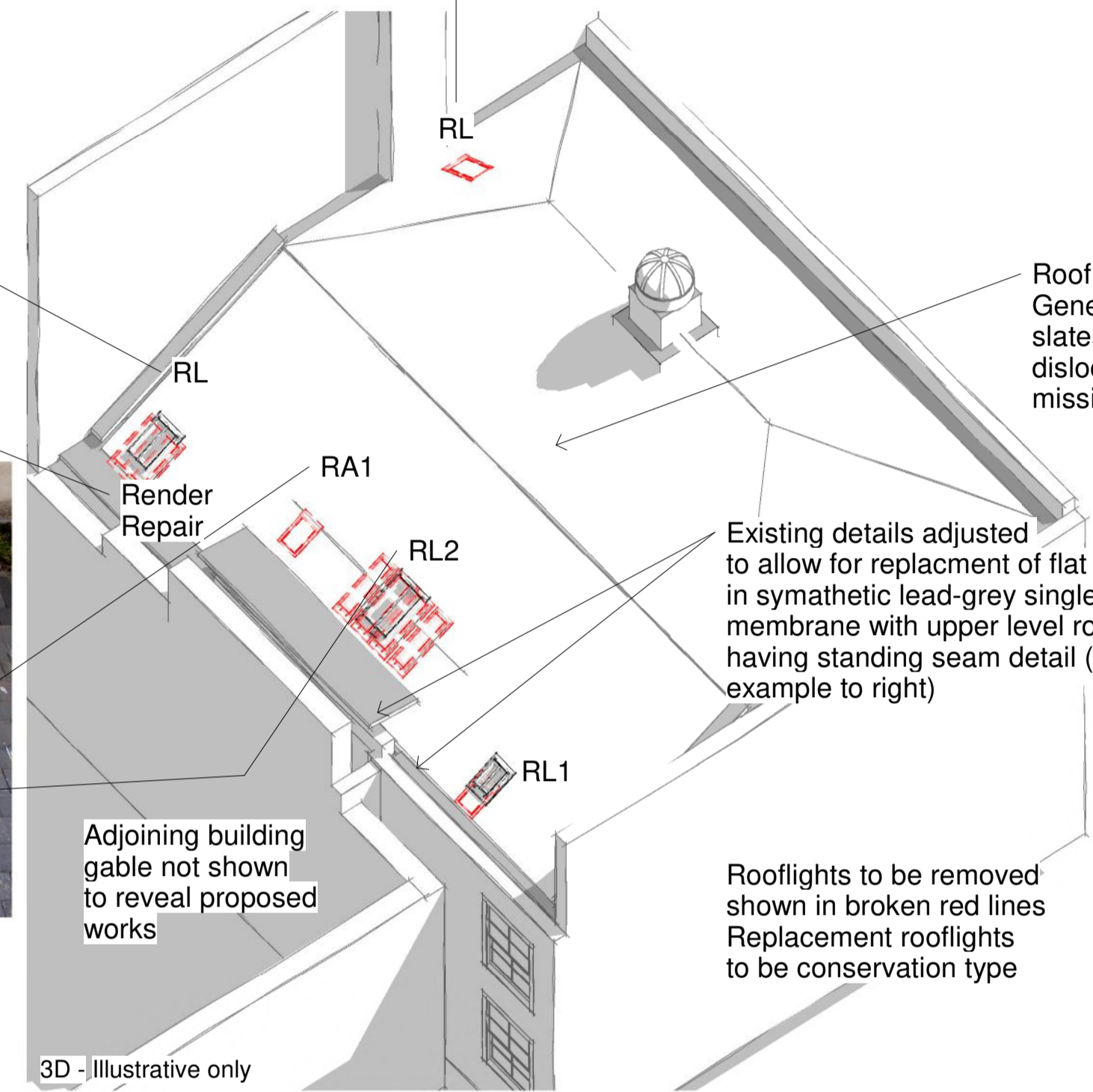

Front Elevation (West) - No works to be carried out

RESPONSIBILITY IS NOT ACCEPTED FOR OTHERS SCALING DIRECTLY FROM THIS DRAWING. DO NOT SCALE FROM THIS DRAWING. USE WRITTEN DIMENSIONS ONLY.

ORIGINAL SHEET SIZE **A1**

1:50

THIS DRAWING IS PRODUCED FOR USE IN THIS PROJECT ONLY AND MAY NOT BE USED FOR ANY OTHER PURPOSE. THE ORIGINATOR ACCEPTS NO LIABILITY FOR THE USE OF THIS DRAWING OTHER THAN THE PURPOSE FOR WHICH IT WAS INTENDED IN CONNECTION WITH THIS PROJECT AS RECORDED IN THE 'PURPOSE FOR ISSUE' AND 'FILE STATUS CODE'.

THIS DRAWING MAY NOT BE REPRODUCED IN ANY FORM WITHOUT PRIOR WRITTEN AGREEMENT.

© CROWN COPYRIGHT AND DATABASE RIGHTS - ORDNANCE SURVEY LICENCE NUMBER 100019340.

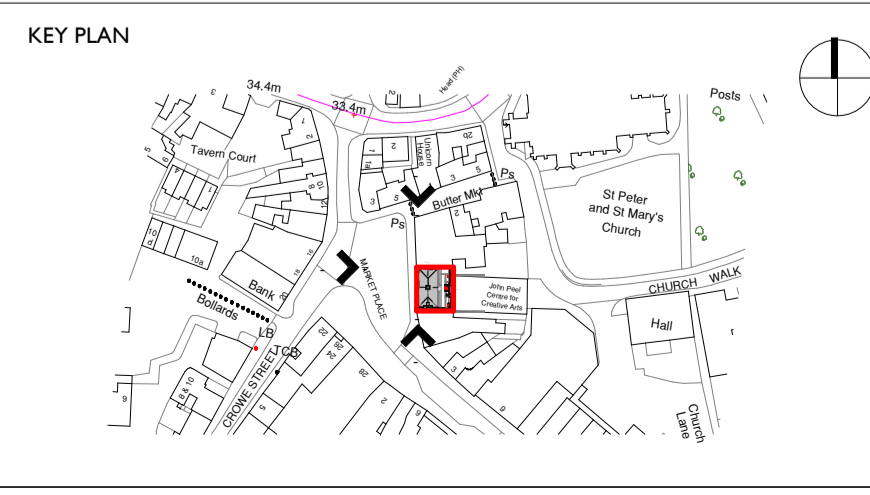

NOTES

Rev	Description	Date
P00	Draft Planning	26/7/22
P01	Revised for planning resubmission	10/11/22
P02	Works to Cupola removed	24/11/22
P03	Example RL photo removed	04/01/23

CLIENT
Babergh and Mid Suffolk District Councils

PROJECT
11 Market Place, Stowmarket, Suffolk, Roof Repairs

TITLE
Planning Drawing

SCALE	DISCIPLINE	PROJECT NUMBER
As indicated	Surveying	111405
DRAWING NUMBER	REV CODE	
61	P03	
STATUS CODE	PURPOSE OF ISSUE	
s2	Planning	

Hamson Barron Smith

NPS Norwich
5 Anson Road
Norwich
NR6 6ED
npsplc@nps.co.uk